



www.cymarcbikeparts.co.uk
Unit 4D, Lakeside Enterprise Park, Birkdale Road
Scunthorpe, North Lincolnshire, DN17 2AU
Phone: 07715 681911 or 07713 789365
Email: mick@cymarc.co.uk

INSTRUCTIONS FOR FITTING THE SCREEN STRENGTHENING BRACKETS (PAIR) TO THE R/SERIES GS(A) LC ALL MODELS

Fitting the windscreen strengthening brackets is very easy, as follows, but if you get stuck then please give us a call, if we can't help you over the phone, we are happy to fit it for you at our workshop (fitting charges apply). We also have an installation video on our Cymarc Bike Parts YouTube channel which we highly recommend you view. The kit assembles as below image and includes...

- 2 x Lower brackets (Arms)
- 2 x Upper brackets (Mushrooms)
- 4 x M6x25 Torx socket Cap head fasteners
- 4 x M6 spring washers
- 4 x M6 washers
- 4 x M6x18 washers
- 2x M6 ext. tooth washers
- 2 x M5x15 socket button head fasteners
- 2 x M5 Washers
- 6 x M6x14g Stainless steel rivet bushes *already pressed into the lower brackets*
- 2 x M6 Hand wheels (handle may vary in size/design)

To fit, first remove the Winglets/Air deflector assembly for easy access first, then...

- Remove inner screen trim fastener and loosely fasten the mushroom bracket with supplied M5 fastener and washer (or reuse OEM fastener if you prefer).
- Loosely fit lower bracket arms with M6 fasteners using supplied M6 washers and spring washers, and ensure that the rivet bushes on each side are facing each other.
- Fit the thumb screw with the M6x18 washers and ext. tooth washer and locate into M6 rivet bush at top of lower bracket.
- When everything is `naturally` lined up fasten M5 & M6 fasteners properly.
- Loosen thumb screw, reposition screen to ideal height setting then tighten up thumb screws.
- Replace winglets/air deflector assembly.

Note* The small tips of the mushroom top brackets face upward when mounted to the wind screen.

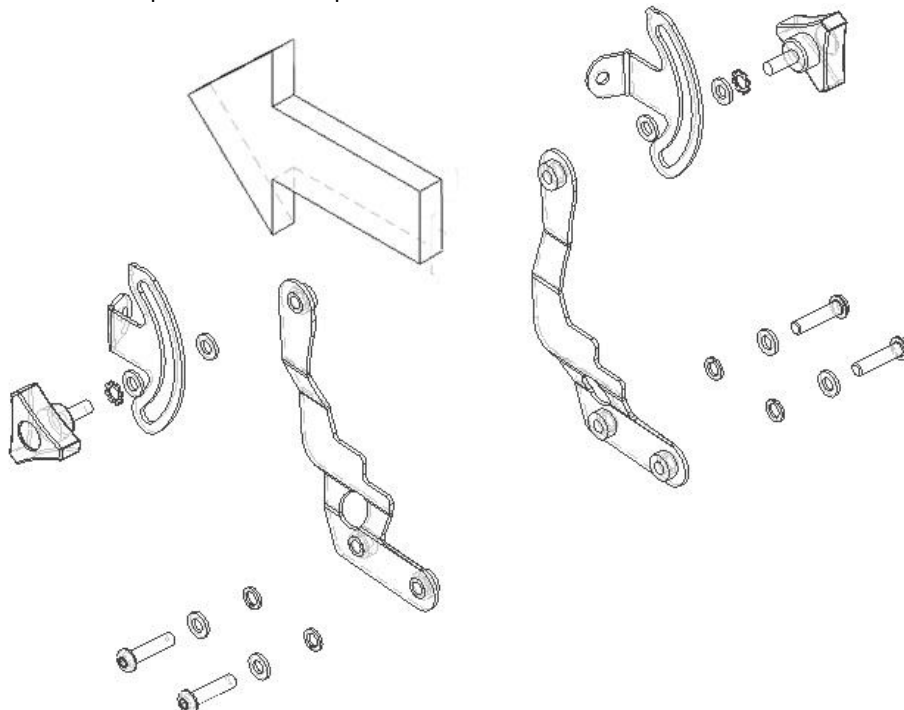

The kit assembles as above - Arrow indicates the front of the bike

TIP: we recommend the use of Teflon tape on the hand wheel threads as some bikes suffer from vibrations.